

Cynthia A Duncan
Dr. Virgil G. Fredenberg
EDMA 655
February 7, 2015

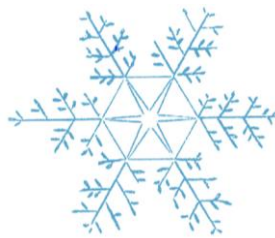

Place-Based Problem #
Volume

What is the total volume of snow on the Keet Gooshi Heen Elementary School playground if it was covered with snow two feet deep?

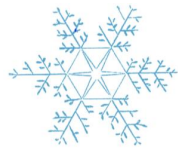
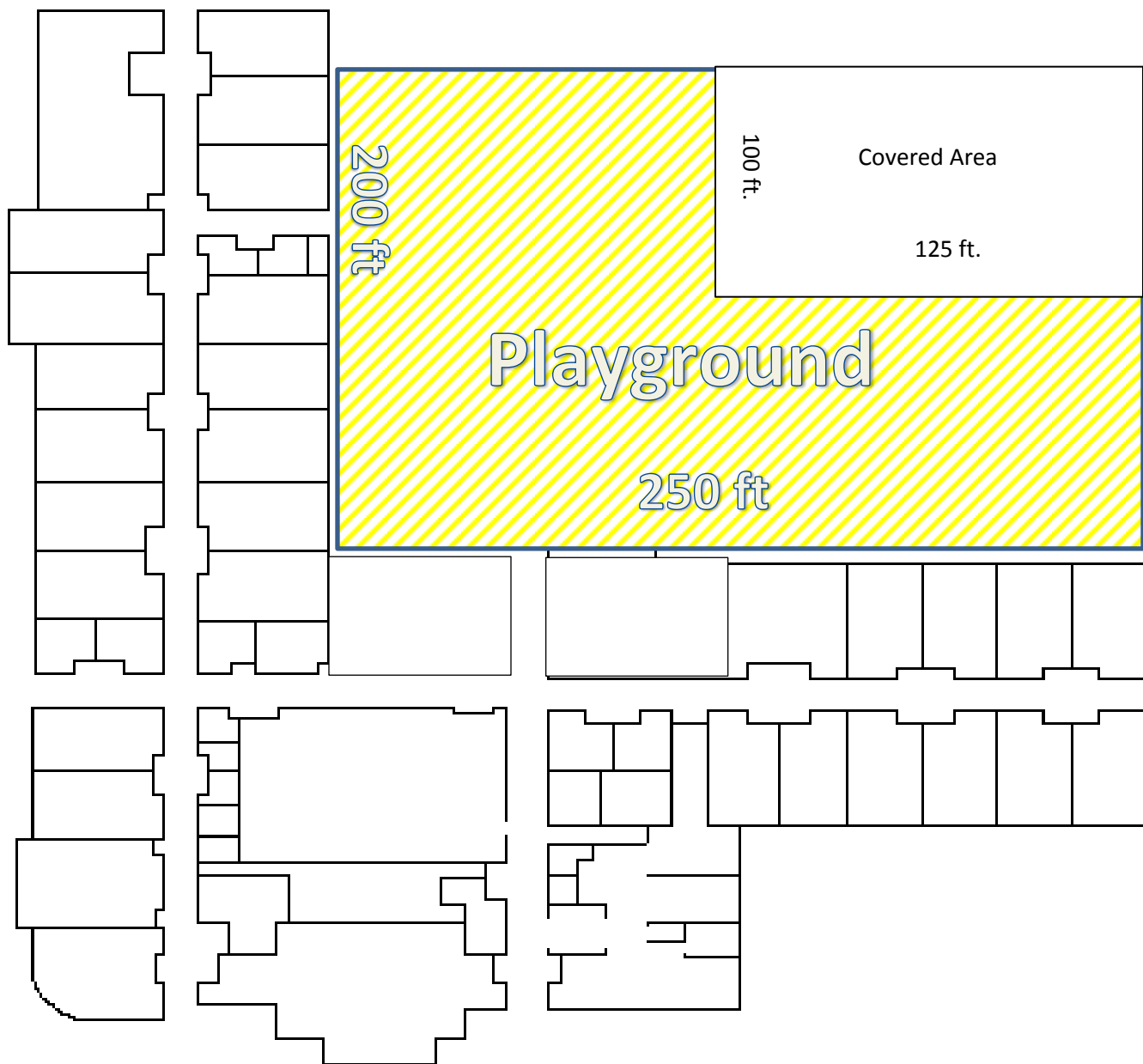

work sample

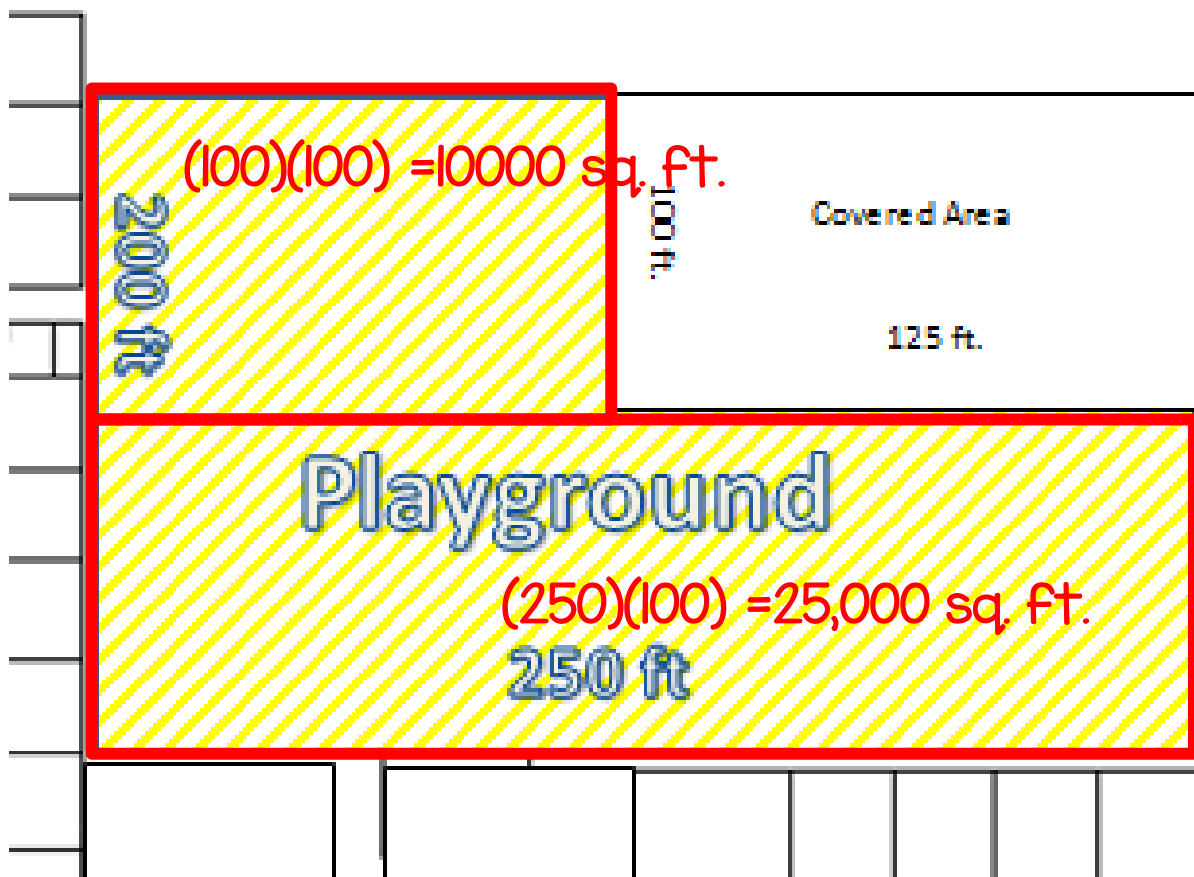

Area of the playground is $35,000 \text{ ft}^2$

Volume of Snow on Playground if snow is 2 feet deep:

$$(2\text{ft}) (35,000 \text{ ft}^2)$$

$$70,000\text{ft}^3$$

If it snowed and the playground was covered with snow that was 2 feet deep then the volume of snow of the playground would be

$$70,000\text{ft}^3$$